

INSTRUCTION MANUAL

1CH,2CH,3CH,4CH

Zigbee Switch Module-L

(No Neutral Wire Required)

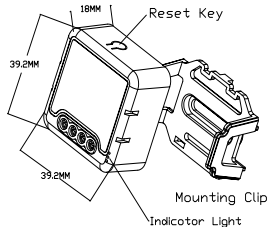

Wiring Instructions and Diagrams

1. Turn off the power supply before carrying out any electrical installation work.
2. Connect wires according to the wiring diagram.
3. Insert the module into the junction box.

Turn on the power supply and follow switch module configuration instructions.

4. Flash after lights off Please attach accessories.

Warnings : Do not connect the neutral line, Otherwise it will be permanently damaged.

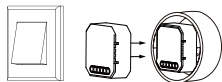

Wiring diagram of fittings

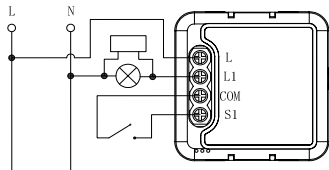

TECHNICAL SPECIFICATIONS

Product type	Zigbee Switch Module-L
Voltage	AC200-240V 50/60Hz
Max. load	1CH: 10-100W 2CH: 2x(10-100W) 3CH: 3x(10-100W) 4CH: 4x(10-100W)
Operation frequency	2.405GHz-2.480GHz
Operation temp.	-10°C + 40°C
Protocol	IEEE802.15.4
Operation range	<100m
Dims (WxDxH)	39.2x39.2x18 mm
IP rating	IP20
Warranty	2years
Certificates	CE ROHS

with mounting clip

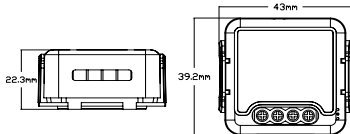

1CH Zigbee Switch Module-L

Single Control

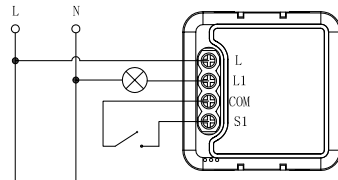

Double Switch

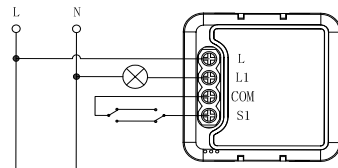

INSTALLATION

Warnings:

1. Installation must be carried out by a qualified electrician in accordance with local regulations.
2. Keep the device out of reach of children.
3. Keep the device away from water, damp or hot environment.
4. Install the device away from strong signal sources such as microwave oven that may cause signal interruption resulted to abnormal operation of the device.
5. Obstruction by concrete wall or metallic materials may reduce the effective operation range of the device and should be avoided.
6. Do NOT attempt to disassemble, repair or modify the device.

2CH Zigbee Switch Module-L

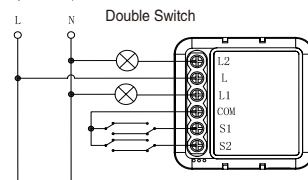
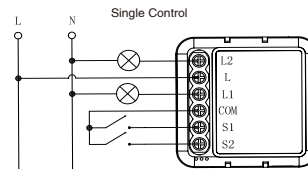

Wiring diagram of fittings(L1 L2 One of them)

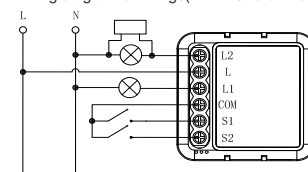

FAQ

Q1: What should I do if I can't configure the switch module?

- a. Please check whether device is powered on.
- b. Make sure the Zigbee Gateway is available.
- c. Whether it's in good internet conditions.
- d. Make sure the password entered in App is correct.
- e. Make sure the wiring is correct.

Q2: What device can be connected to this Zigbee switch module? such as ceiling lamp, panel light, etc.

Q3: What happens if the WIFI goes off?

You can still control the device connected to the switch module with your traditional switch and once WIFI is active again the device connected to module will connect automatically to your WIFI network.

Q4: What should I do if I change the WIFI network or change the password?

You have to re-connect our Zigbee switch module to the new Wi-Fi network accordingly as per the App User

Q5: How do I reset the device?

1. Switch on/off the traditional switch for 5 times until the indicator light flash.
2. Press the reset key for about 10 seconds until the indicator light flash.

3CH Zigbee Switch Module-L

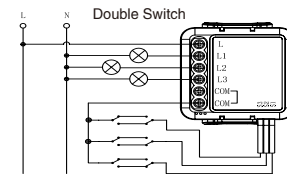
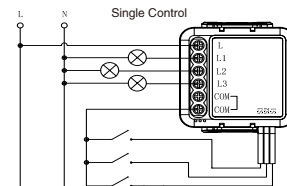

Wiring diagram of fittings(L1 L2 L3 One of them)

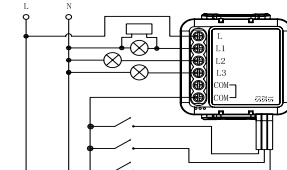

4CH Zigbee Switch Module-L

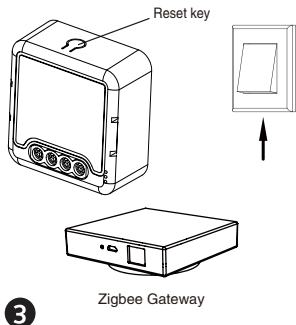
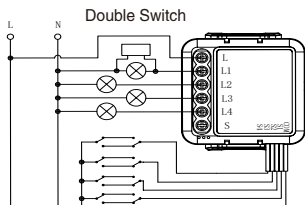
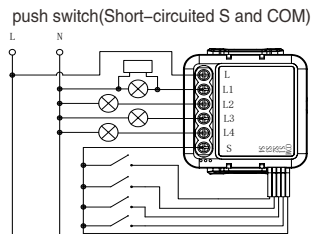
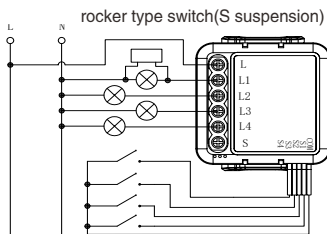

After the wiring of switch module is done, press the reset key for about 10 seconds or turn on/off the traditional switch for 5 times until the indicator light inside the module is flashing quickly for pairing.



Click "+" (Add sub-device) to select the suitable product gateway and follow the on-screen instruction for pairing.

APP USER MANUAL



1 IOS APP / Android APP

Scan the QR code to download Tuya Smart App, or you can also search keyword "Tuya Smart" at App Store or Googleplay to download App.

Log in or register your account with your mobile number or e-mail address. Type in the verification code sent to your mobile or mail box, then set your login password. Click "Create Family" to enter into the APP.

2

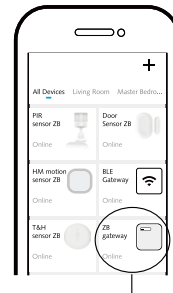

Open the control panel of the ZigBee gateway on the App

Before making the reset operation, pls make sure the Zigbee Gateway is added and installed to the WIFI network. Ensure that the product is within the range of Zigbee Gateway Network.

SYSTEM REQUIREMENTS

- WIFI[®] Router
- ZigBee gateway
- iPhone, iPad (IOS 7.0 or higher)
- Android 4.0 or higher

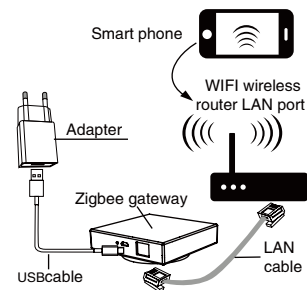

5

The connecting will take about 10-120 seconds to complete depending on your network condition.

Finally, you can control the device via your mobile phone.